

 **FAIRLINE**

PHANTOM 65

BELIEVE IN PERFECTION



BELIEVE IN THE IMPOSSIBLE BELIEVE IN THE ALL-NEW PHANTOM 65



It's time to believe the perfect yacht can exist

Some say a phantom cannot be real and can only exist in one's mind. We say otherwise. We say it's time for luxury and exhilaration to co-exist. It's time for the Phantom 65.

Inspired by the award-winning design of our Targa 65, the latest addition to the Fairline family raises the bar on every level. Within every line, every detail, and every feature, you'll find the perfect balance of unparalleled calm and unrivalled excitement.

So, if you're ready to believe in a yacht like no other, it's time you stepped aboard the Phantom 65.



THE POWER TO ENCHANT, THEN ENTHRAL

Relaxation and excitement are states of mind. They exist together on the Phantom 65 and can change at the push of a throttle. Unwind in perfect luxury as you watch the world go by with champagne in hand, then climb up to the sportbridge and experience the exhilaration as the world flies by at up to 35 knots with the Phantom's intuitive steeringwheel in hand.

Highlights

- A panoramic, single piece windscreen for uninterrupted views from the luxurious saloon
- 3 or 4 cabins / 3 or 4 heads layouts, all with the option of ensuite shower-rooms, so you can comfortably host your friends and family
- Our master cabin features a forward-facing bed, mini-sofa, vanity desk, generous hull windows and a large ensuite
- Multiple dining locations including lounge, aft deck and foredeck thanks to varying size and height of tables
- Enjoy both upper and lower driving positions with our innovative and exciting Sportsbridge, both with co-pilot seating
- Spacious saloon with large aft gallery and dinette, making entertaining effortless
- Large integrated garage to house a Williams 345 SportJET, ideal for island hopping or jetting off to your favourite beach restaurants
- Stylish modern interior that elevates luxurious accommodation to a whole other level
- A comfortable single berth cabin for a crew member, so you can look after them, as well as they look after you

AS THRILLING AS IT IS LUXURIOUS

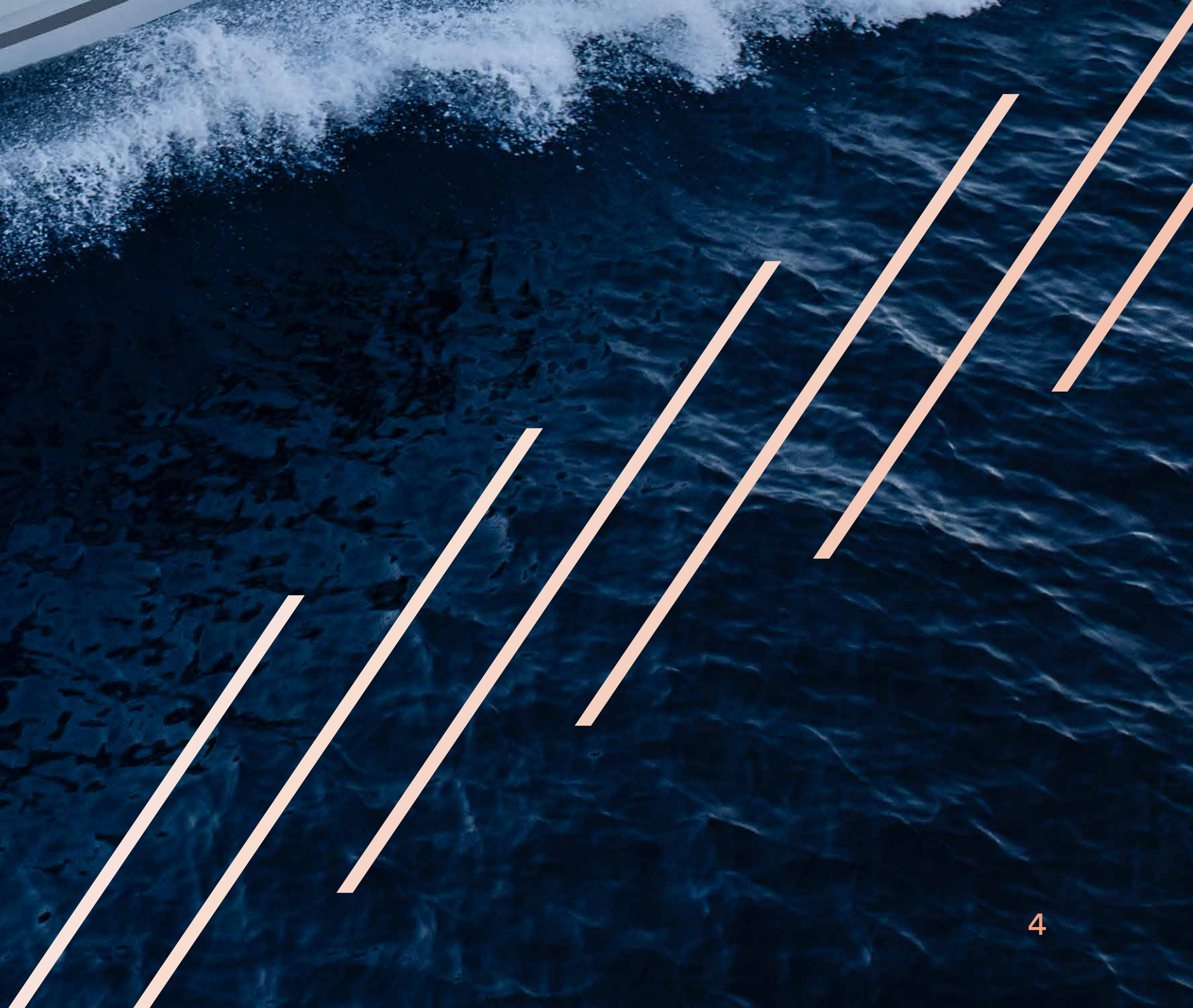











AN INTERIOR THAT'S AS SERENE AS THE MEDITERRANEAN BREEZE ITSELF

PHANTOM 65

Our fresh modern interior has been designed to give you a true sense of calm from the moment you step aboard. With earth tones, deep blue hues, natural weaves and linen textures, our interior collection feels as calm as the waves that gently lap against the shore.

As one luxurious space flows effortlessly into the next, thanks to dynamic diagonal lines and an array of beautifully handcrafted materials, you can relax knowing wherever you are onboard, you'll feel perfectly at peace. And with up to four cabins and eight berths, there is no shortage of luxury accommodation.

For any help and guidance on finding the perfect theme for you, simply contact your local dealership.



MAKING EVERY MILLIMETRE MATTER

PHANTOM 65

PRINCIPAL DIMENSIONS

Length overall	65'4" (19.96m)
Beam (inc. gunwale)	17'2" (5.23m)
Draft	5'2" (1.58m) unloaded
Airdraft	20'6" (6.29m)
Berths	6 - 9
Fuel capacity	919 gallons / 1103 US gallons (4177 litres)
Water capacity (inc. calorifier)	237 gallons / 285 US gallons (1080 litres)
Dry weight (approx)	38.3 tonnes / 42.2 US tons (38,000kg)
Type approval	CE Category B
Capacity	16 people

ENGINES AND PERFORMANCE

Twin Caterpillar C18-1150
Max. speed: 31 knots (estimated)
Max. power: 2300 hp
Fuel: Diesel
Drive: Shaft

Twin Caterpillar C32-1622
Max. speed: 35 knots (estimated)
Max. Power: 3224 hp
Drive: Shaft
Fuel: Diesel



MAIN DECK

PHANTOM 65

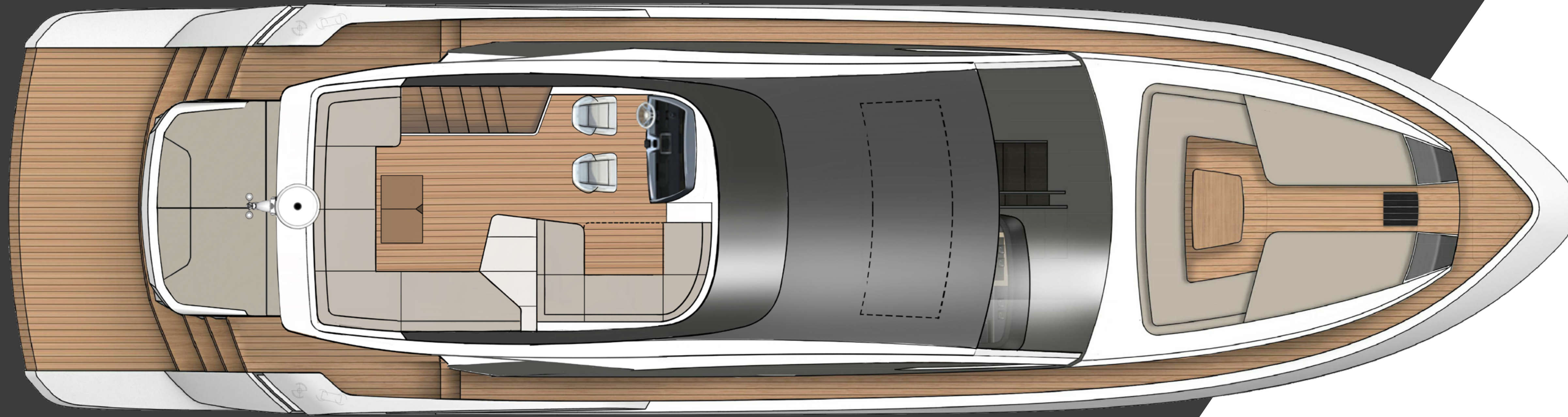

SPORTBRIDGE DECK

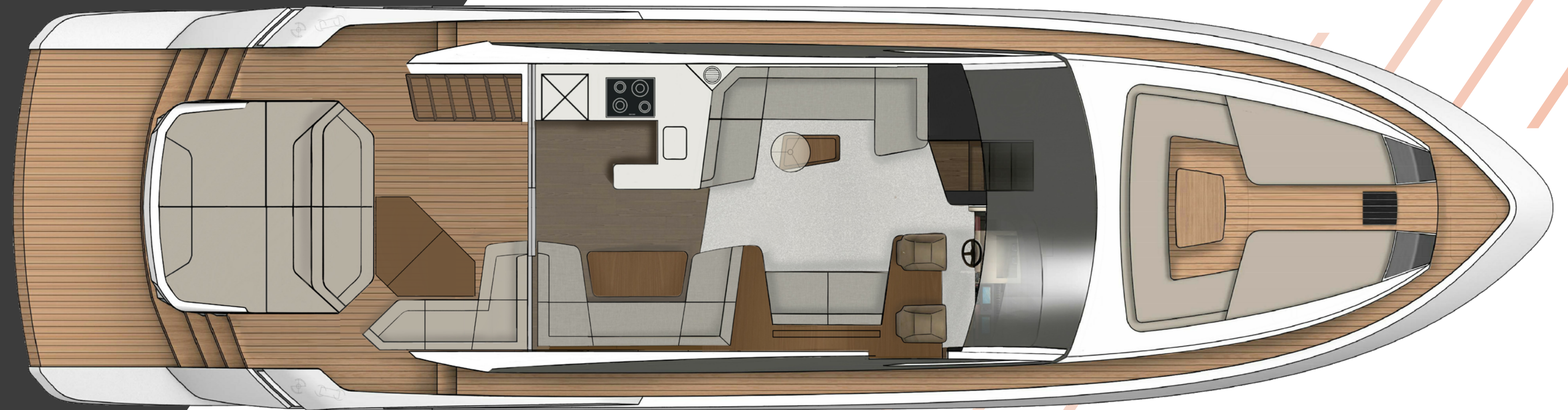

MAIN DECK

LOWER DECK

PHANTOM 65

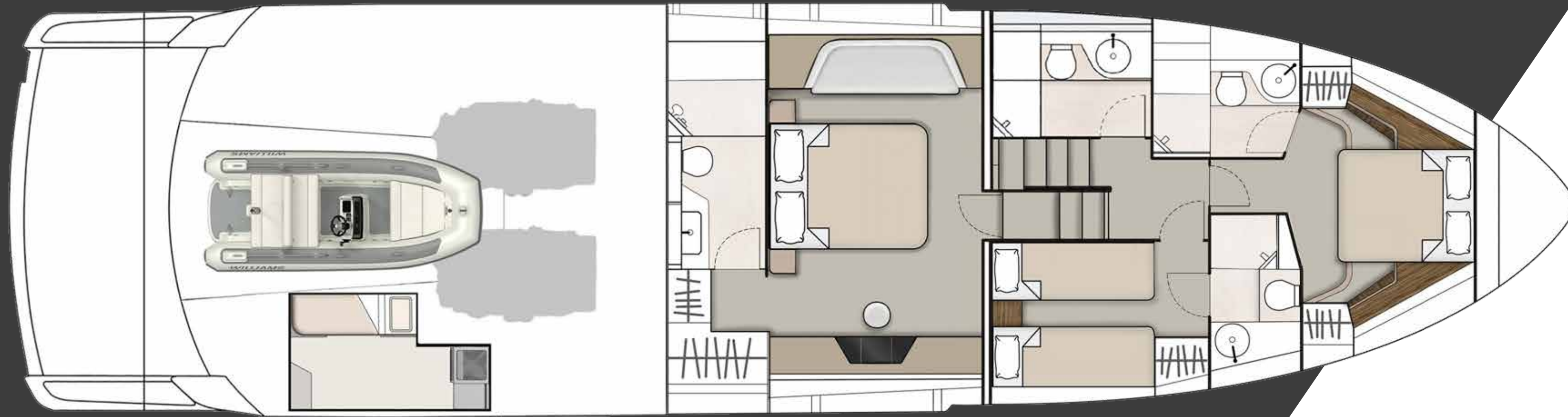

THREE CABIN

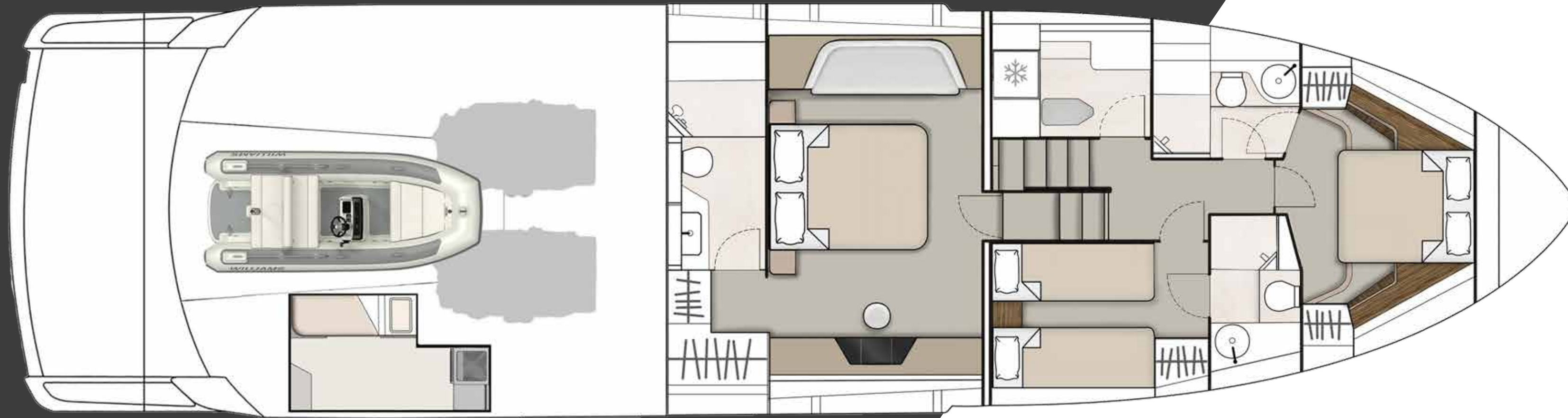

THREE CABIN WITH UTILITY ROOM

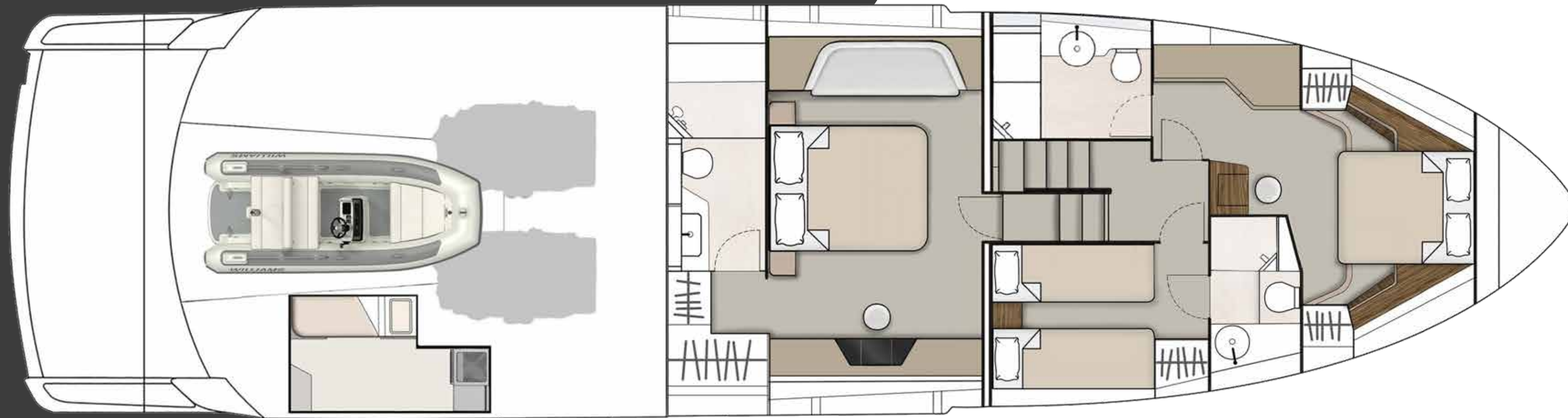

THREE CABIN WITH EXTENDED VIP

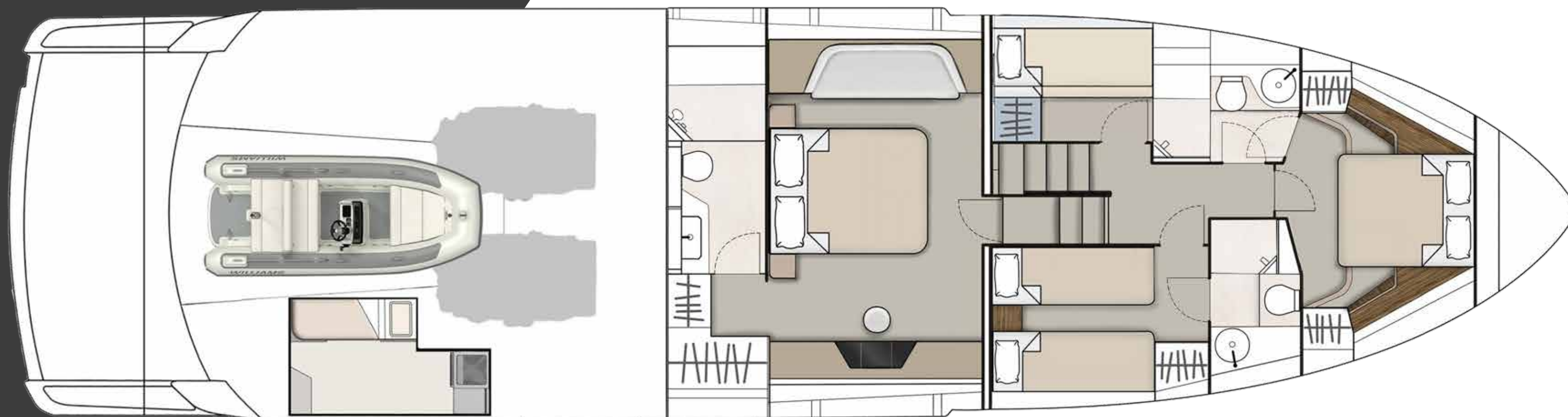

FOUR CABIN

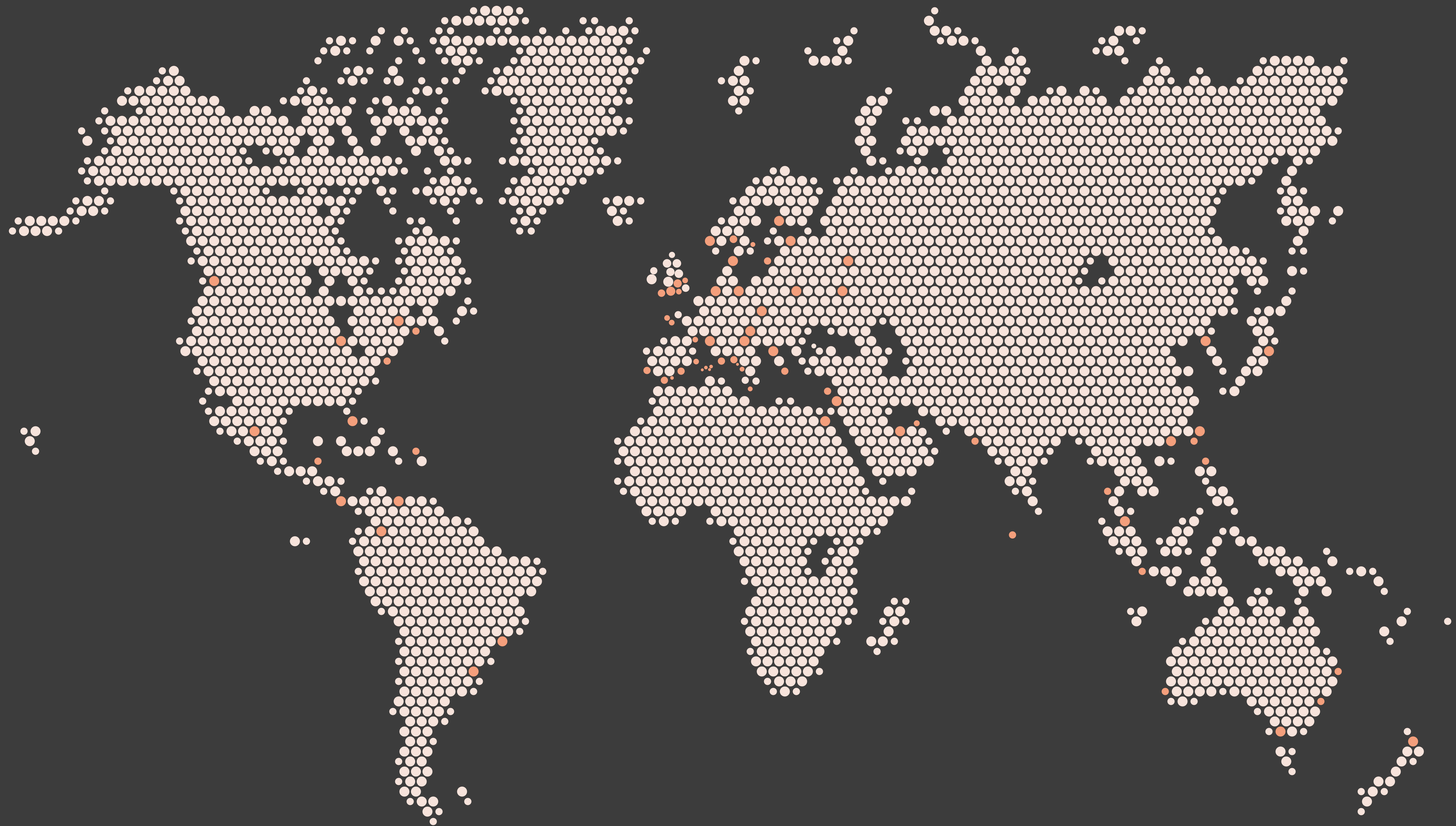

FROM DEALERSHIP, TO FRIENDSHIP

As you'd expect, each and every one of our appointed Fairline dealers around the world is a faultless professional who'll work tirelessly to provide you with a yacht that's perfect in every way imaginable.

However, what really sets them apart is their dedication to looking after you like a trusted friend and member of the Fairline family, right from the very first moment you speak.

To speak to your nearest Fairline dealer, visit: [fairline.com](https://www.fairline.com)



DON'T JUST READ ABOUT IT, EXPERIENCE IT

At Fairline we know nothing compares to actually stepping onboard our new Phantom 65. So, once you've had a chance to peruse the deck plans and read the specifications, why not contact your local dealer to arrange a personal guided tour?



FAIRLINE



[fairline.com](https://www.fairline.com)

© FAIRLINE YACHTS LTD 2022. ALL RIGHTS RESERVED. FAIRLINE AND PHANTOM ARE REGISTERED TRADEMARKS OF FAIRLINE YACHTS LTD. TOGETHER WITH ALL TEXT AND IMAGES CONTAINED IN THIS PUBLISHED MATERIAL, THEY ARE PROTECTED BY COPYRIGHT AND MAY NOT BE PRODUCED IN ANY FORM WITHOUT THE EXPRESS WRITTEN PERMISSION OF THE COPYRIGHT OWNERS. Published by Fairline Yachts Ltd, Oundle, PE8 4HN, England. Fairline Yachts constantly seek ways of improving specifications, design and production. Therefore, alterations take place on a continuous basis. Whilst every effort is made to produce up-to-date literature, the descriptions, specifications, illustrations and photographs in this brochure should not be regarded as a definitive guide to current specifications, nor does it constitute an offer for the sale of any particular boat. Appointed dealers are not agents of Fairline Yachts Ltd & are not authorised to commit Fairline Yachts Ltd by any express or implied undertaking or representation.

Performance estimates are given in good faith, but are in no way guaranteed for any particular boat. Dirt on the bottom of the boat, damage to propellers, engine tuning, external water and air temperatures and the weight of crew, fuel and water carried can all adversely affect performance. For these and other reasons we can give no performance guarantees.